



**Towing hitch accessories:**

Pos. 1 Main bar PCS.: 1	Pos. 7 Handle II PCS.: 2	Pos. 14 Bolt 8.8 B M12x40mm PCS.: 11	Pos. 21 Spring washer ø10,2mm PCS.: 6
Pos. 2 Tow ball (mounting set) PCS.: 1	Pos. 8 Square washer I PCS.: 1	Pos. 15 Bolt 8.8 B M10x1,25x40mm PCS.: 4	Pos. 22 Nut 8 B M12 PCS.: 10
Pos. 3 Socket plate PCS.: 1	Pos. 9 Square washer II PCS.: 1	Pos. 16 Bolt 8.8 B M10x40mm PCS.: 2	Pos. 23 Nut 8 B M10 PCS.: 2
Pos. 4 Right bracket PCS.: 1	Pos. 10 Fish-plate with nut M12 PCS.: 4	Pos. 17 Plain washer ø13mm PCS.: 12	
Pos. 5 Left bracket PCS.: 1	Pos. 11 Handle III PCS.: 1	Pos. 18 Washer ø37xø13x3mm PCS.: 6	
Pos. 6 Handle I PCS.: 1	Pos. 12 Bolt 8.8 B M12x130mm PCS.: 2	Pos. 19 Washer ø30xø10,5x2,5mm PCS.: 8	
	Pos. 13 Bolt 8.8 B M12x60mm PCS.: 1	Pos. 20 Spring washer ø12,2mm PCS.: 14	

**Towing hitch (without electrical set)**

Class: A50-X Cat. no. **R42A**

**FIAT DUCATO L4,  
PEUGEOT BOXER L4,  
CITROEN JUMPER L4**

Type: **metal built-up**  
produced since 2006

Technical data:

**D-value: 16,13 kN**

maximum trailer weight: **3100 kg**

maximum vertical cup load: **124 kg**

Approval number according to Directive 94/20/EC: **e20\*94/20\*0495\*00**

Figure 2. Drilling only for vehicles produced since 2010:

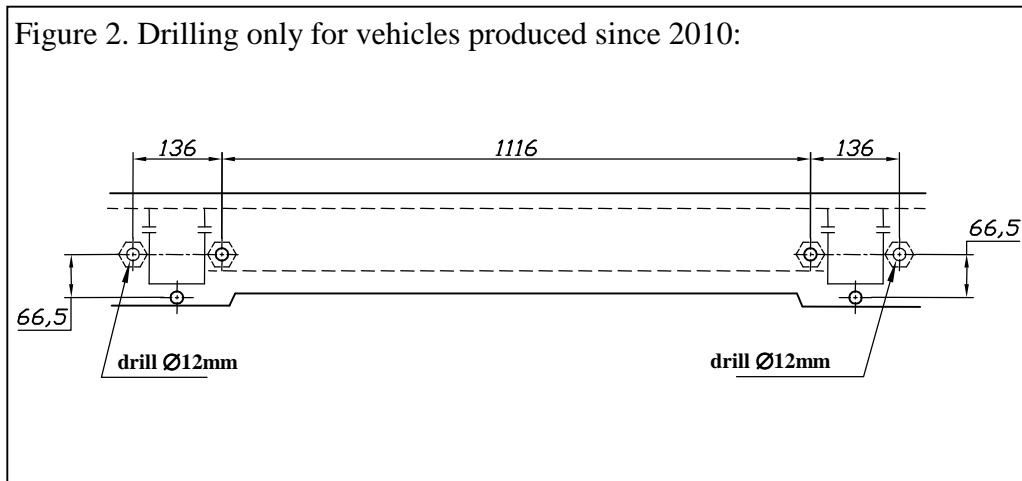

**Foreword**

This towing hitch is designed according to rules of safety traffic regulations. The towing hitch is a safety component and can be install only by qualified personnel. Any alteration or conversion of the towing hitch is prohibited and would lead to cancellation of design certification. Remove insulating compound and underseal from vehicle (if present) in the area of the matting surfaces of the towing hitch.

The vehicle manufacturer's specifications regarding trailer load and max. vertical cup load are decisive for driving whereat values for the towing hitch cannot be exceeded.

D-value formula:

$$\frac{\text{Max trailer weight [kg]} \times \text{Max vehicle weight [kg]}}{\text{Max trailer weight [kg]} + \text{Max vehicle weight [kg]}} \times \frac{9,81}{1000} = D \text{ [kN]}$$

## FITTING INSTRUCTION

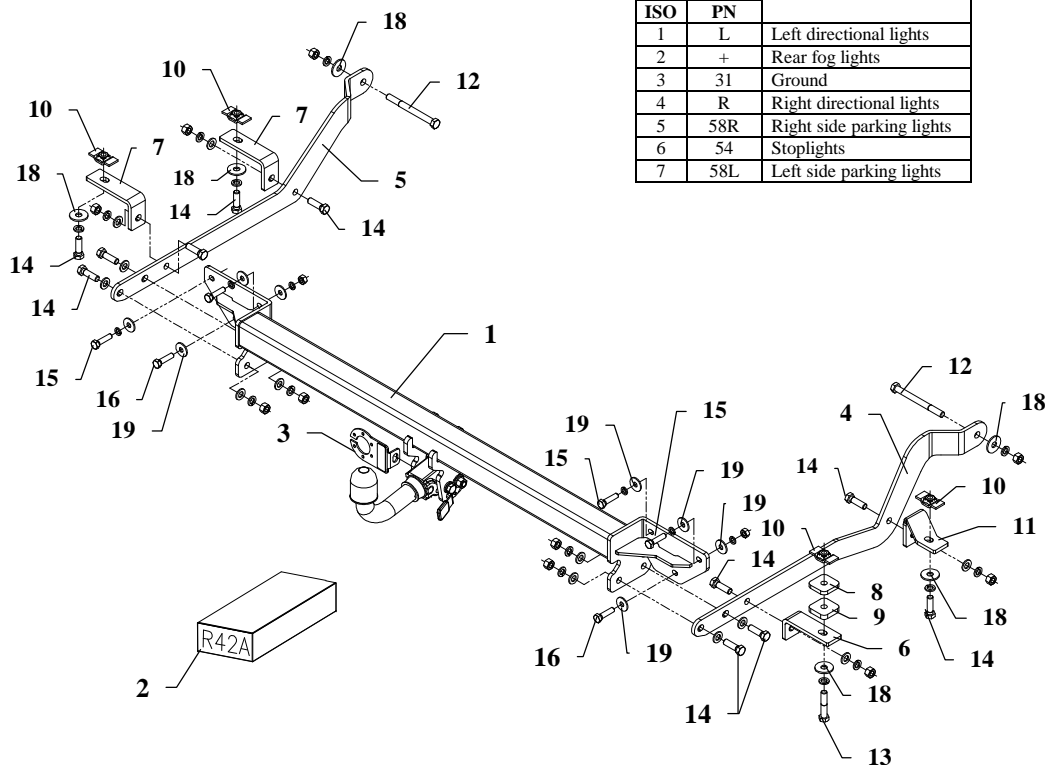

Clamp mark in acc. with		Cables joining
ISO	PN	
1	L	Left directional lights
2	+	Rear fog lights
3	31	Ground
4	R	Right directional lights
5	58R	Right side parking lights
6	54	Stoplights
7	58L	Left side parking lights

This towing hitch is designed to assembly in following cars: **FIAT DUCATO L4, PEUGEOT BOXER L4, CITROEN JUMPER L4, metal built-up**, produced since 2006, catalogue no. **R42A** and is prepared to tow trailers max total weight up to **3100 kg** and max vertical load **124 kg**.

### From manufacturer

Thank you for buying our product. Their reliability has been confirmed in many tests. Reliability of towing hitch depends also on correct assembly and right operation. For this reasons we kindly ask to read carefully this instruction and apply to hints.

*The towing hitch should be installing in points described by a car producer.*

## The instruction of the assembly

- Disassemble a bumper and metal reinforcement (reinforcement will not be reinstall).
- NOTE! Only for vehicles produced till 2010:**  
Instead of metal reinforcement fix main bar of the towbar (pos. 1) using four bolts M8 (take from disassembled reinforcement) and two bolts M10x40mm pos. 16 from towbar accessories.
- NOTE Only for vehicles produced since 2010:**  
Drill two holes  $\varnothing 12\text{mm}$  according to figure 2 (drill very carefully, do not damage thread of nuts welded inside). Instead of metal reinforcement fix main bar of the towing hitch (pos. 1) using four bolts M10x1,25x40mm (pos. 15) and two bolts M10x40mm (pos. 16) from towing hitch accessories. Remember about large washers (pos. 19)
- Underneath the car find plastic square plugs in the frame. Remove them. In holes put fish-plates with nuts (pos. 10). Two per each side of the chassis, see figure.
- Fix side brackets (pos. 4 and 5) to main bar of the towing hitch using bolts M12x40mm (pos. 14) and M12x130mm (pos. 12) to the frame of car as shown on the figure.
- Fix side handles pos. 6 (1 pc.), pos. 7 (2 pcs.) and pos. 11 (1pc.) to side brackets using bolts M12x40mm (pos. 14) and next to frame of the car using the same bolts. **NOTE!** Handle pos. 6 fix using bolt M12x60mm (pos. 13) and square washers (pos. 8 and 9) as shown on the figure.
- Reassemble a bumper.
- Fix body of the automat and the socket plate (pos. 3) using bolts M12x25mm from accessories. Place tow-ball according to supplied instruction.
- Tighten all bolts according to the torque shown in the table.
- Connect electric wires of 7-poles socket according to the instruction of the car. (Recommend to make at authorized service station).
- Complete paint layer damaged during installation.

Torque settings for nuts and bolts (8,8):

<b>M6</b> - 11 Nm	<b>M8</b> - 25 Nm	<b>M10</b> - 50 Nm
<b>M12</b> - 87 Nm	<b>M14</b> - 138 Nm	<b>M16</b> - 210 Nm